



TECHNICAL DATA SHEET

ICE CUBE MACHINE



AIM BN 400
ICE BIN

- Tropical class +43°C
- Stay clear condenser
- Zero ODP injected 42 kg/ m3 polyurathane insulation
- Antibacterial storage area
- Silent operation with magnetic pump
- Electronic control Large ice storage bin
- Ergonomic door handle
- Patented nozzle system provides less cycles

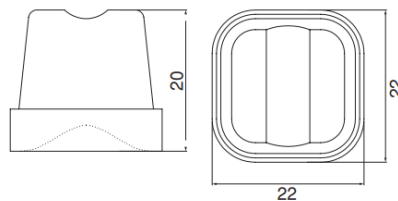

ICE BINS AIM BN 400





TECHNICAL DATA SHEET



GENERAL INFORMATION

Ice Storage Capacity: 220KG

Product Dimension (mm): 880x770x1200

Packing Dimension (mm): 880x810x1350

Product Weight: 63

Packing Product Weight: 73

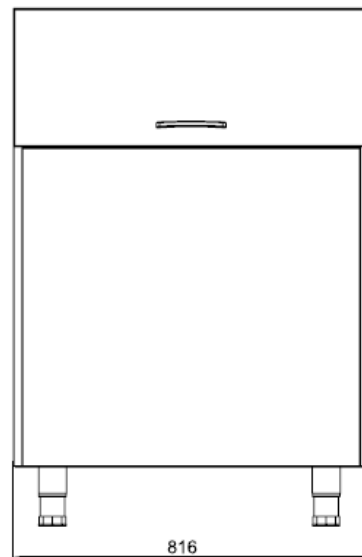
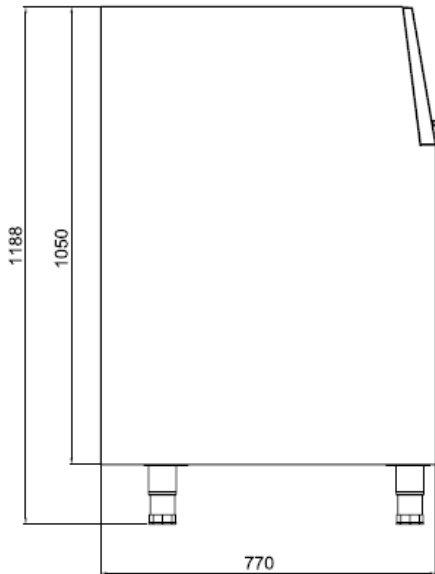

ICE BINS AIM BN 400

