



TECHNICAL DATA SHEET

ICE CUBE MACHINE



AIM BN 200
ICE BIN

- Tropical class +43°C
- Stay clear condenser
- Zero ODP injected 42 kg/ m3 polyurathane insulation
- Antibacterial storage area
- Silent operation with magnetic pump
- Electronic control Large ice storage bin
- Ergonomic door handle
- Patented nozzle system provides less cycles

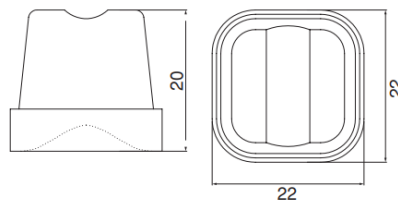

ICE BINS AIM BN 200





TECHNICAL DATA SHEET



GENERAL INFORMATION

- Ice Storage Capacity: 180KG
- Product Dimension (mm): 820x770x1040
- Packing Dimension (mm): 880x810x1200
- Product Weight: 55
- Packing Product Weight: 65

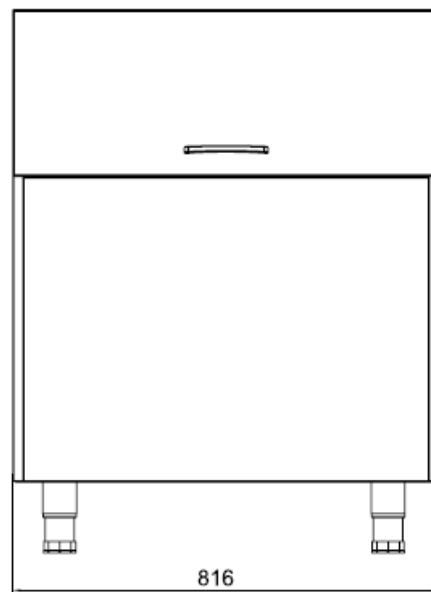
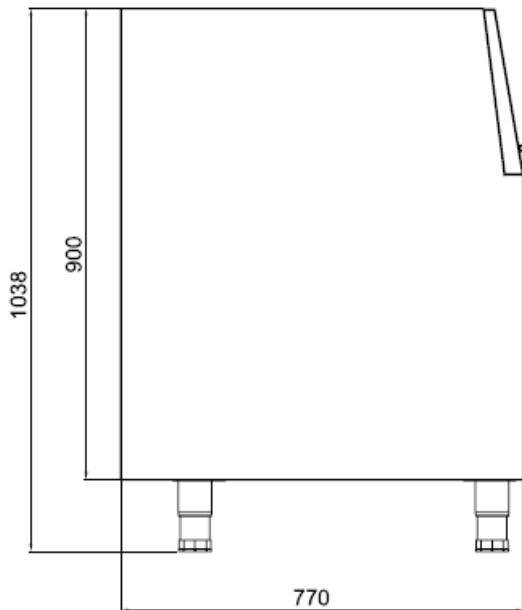

ICE BINS AIM BN 200

